

## Sony CCD High Resolution IR Bullet Camera



600  
TVL



OSD



High  
Light  
Compensation



Backlight  
Compensation



30M



IP 66



Day/Night



Digital  
Noise  
Reduction



Dead  
Pixel  
Compensation



Auto  
Tracking  
White Balance



Wide  
Dynamic  
Range



Anti-  
Flicker



AIR-691V

Model	AIR-691V
Image Sensor	1/3" Sony Super HAD II CCD
Resolution	600 TV Lines
Effective Pixels	NTSC: 768x494 / PAL: 752x582 (H)x(V)
Min. Illumination	0.1 Lux @ F1.8
Lens	2.8-12mm Vari-focal Lens
S/N Ratio	More than 52dB(AGC OFF)
Electronic Shutter	1/60(1/50)~1/100,000sec
Video Output	1.0Vp-p/75 ohm Composite
Sync. System	Internal
OSD	Built-in OSD Menu
White Balance	ATW/AWC (PUSH LOCK)/Manual
Shutter/AGC	Auto/Manual/FLK
Backlight	BLC/HLC
IR LED	36pcs
IR Distance	30M (100')
Weatherproof	IP 66
Power Source	DC12V +/- 10% @500mA w/IR on
Dimensions	83 (W)x 81 (H)x 262 (D) mm
Weight	550g
Operating Temp.	-10°C to +50°C (-14°F to +122°F)



- A. External adjustment for zoom and focus (2.8-12mm)  
 B. Easy installation for unscrewing the base of the bracket

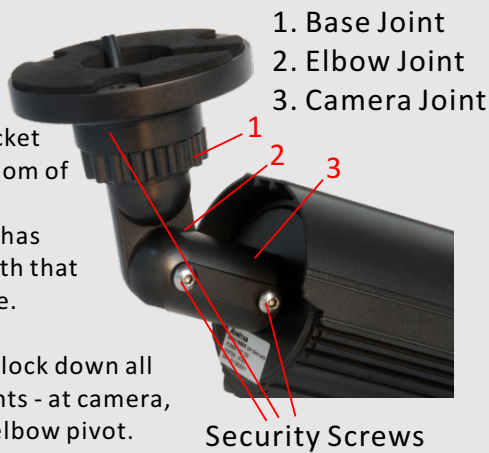

The jointed bracket allows full freedom of movement.

The elbow joint has interlocking teeth that prevent slippage.

Security screws lock down all adjustment points - at camera, at base, and at elbow pivot.

### Easy Camera Setup

The 3-dimensional mini joystick on video/camera cable gives the user quick access to the OSD menu.



SETUP	
LENS	MANUAL
EXPOSURE	↙
WHITE BAL	ATW1
BACKLIGHT	OFF
DAY/NIGHT	COLOR
DPC	OFF
SPECIAL	↔
RESET	↔
EXIT	↔

OSD Control

