

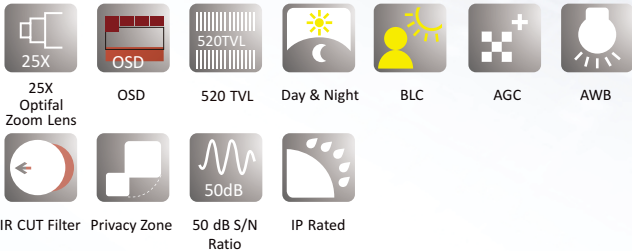

ASP-2520

Features

- 25X Optical Zoom Lens (3.43 ~ 85.7mm)
- Higher Horizontal Resolution of 520 TV Line
- Automatic / Manual Iris Control
- Preset ID / Name
- Preset Background Environment File
- Private Mask
- Up to 128 Programmable Preset Positions
- RS - 485 Control Interface
- Up to 256 Fast Dome Configuration
- Auto Tracking (St025 / 030 / 035)



Install

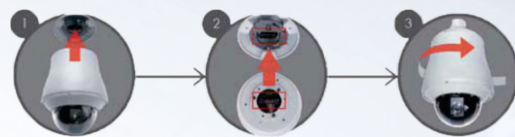

Bracket



IP FAST DOME CAMERA SERIES

25X D/N Super High Resolution IR Fast Dome IP Camera Series

General	Module	ASP-2520
	System	NTSC / PAL
	Schedule Setting	Alarm Input / Auto Mode / Daylight Saving
	Power Consumption	Standard model 22 W * Heater : ON / Tracking model 24 W (Heater : ON)
	Image Pick-up Device	Sony 1/4" Exview HAD CCD
	Effective Pixels	768(H) X 494(V) / 752(H) X 582(V)
	Scanning System	2 : 1 Interlace
	Scanning Frequency	15.734KHz (H), 59.94KHz (V) / 15.625KHz(H), 50HZ(V)
	Synchronization	Internal / Line Lock Selectable
	Video Output	CVBS 1.0 Vp-p / 75 BNC
	Horizontal Resolution	Color : 520 TV Lines, Mono : 580 TV Lines
	Signal to Noise Ratio	More Than 50 dB (AGC : Off)
	Min Illumination	Color: 0.1 Lux at F1.6, 0.01 Lux at F1.6
	Ambient Operation Temperature	-10 C ~ +50 C (14 F ~ 122 F)
	Pan & Tilt	Operation Humidity
Dimensions		326mm(H) * 210mm(D)
Weight		3.2Kg
Heater Activation		On: 15, Off: 25
Fan Activation		On: 35, Off: 25
Panning Degree		360° Endless
Panning Mode		Manual, Auto, Manual Position, Sequential Position
Panning Speed		Manual Apporx 0.15° / s ~ 120° / s 8 Steps, Preset Approx . 1° / s ~ 255° / s, Alarm Trigger Speed 360° / s
Tilting Degree		-6° ~ 96°
Tilting Mode		Manual, Auto, Manual Position, Sequential Position
Lens	Tilting Speed	Manual Apporx 0.15° / s ~ 120° / s 8 Steps, 16/Steps / Preset Approx . 1° / s ~ 255° / s, Alarm Trigger Speed 360° / s
	Zoom Ratio	25X Optical Zoom
	Focal Length	3.43mm ~ 85.7 mm
	Maximum Aperture Ratio	1 : 1.6 (Wide) ~ 3.7(Tele)
	Minimum Object Distance	1.5 m (Tele)
	Iris Range	F/1.6 ~ F/360, Close
Main Function	Angle Field of View	Wide : 68.6° (D) 57.8° (H) 43.7V (V) / Tele 3.12° (D) 2.53° (H) 1.83° (V)
	Control Interface	RS-485 Transmission
	Control Function	Pan and Tilt / Zoom and Focus / Iris and ICR / 128 Preset Position / Home Position / Patrol
	Character Display	On / Off (Preset ID : 16 Alphanumeric Characters, Zoom Ration, Alarm Message, Date / Time, Pan / Tilt Angle)
	Zoom Speed	0 ~ 7 Selectable [7 : Approx. 3.0 Second (Tele to Wide) in Manual Mode] / 0 ~ 7 Selectable [7 : Approx. 3.0 Second (Tele to Wide) in Manual Mode]
	Focus Speed	Slow / MID. / Fast Selectable [Fast : Approx, 2.0 Second (Far to Near) in Manual Mode)
	Auto Focus	Auto / One Push
	Iris	ALC (Adjustable Output Target Level) / Manual
	IR Cut filter	YES
	Password Lock	Function Setup
	Electronic Shutter Speed	Auro / Manual Selectable (1/60 ~ 1/100,000 sec) / Auto / Manual Selectavle (1/50 ~ 1/100,000 sec
	Back Light Compensation	On / Off Selectable
	White Balance	ATW / PUSH / MWB Selectable
	Auto Gain Control	0 ~ 36 dB Selectable
	Auto Mode	Off / AUTO / SEQ / TOUR / PATROL (STOP / PLAY / LEARN)
	Privacy Zone	On / Off Selectable (Up to 8 Zones Settings)
	Image Mirror	On / Off Selectable
	Image Negative	On / Off Selectable
	Alarm Input / Output	6 Input Alarm In 1 ~ 6 (NC / NO) , 1 Output (Alarm Out NC / NO)
	Schedule Setting	Alarm Input / Auto Mode / Daylight Saving Time